

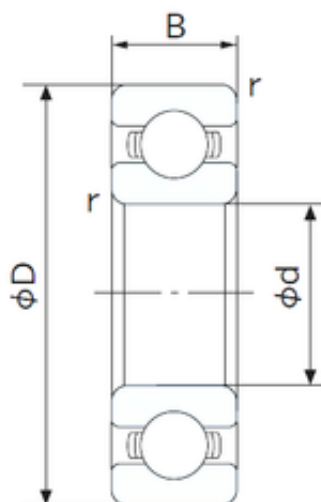

BEARING DRIVESHAFT, INC.



Deep Groove Ball Bearing 6001 2RS C3 6002
2RS C3 6003 2RS C3 6008 2RS C3 NSK NTN
NACHI Koyo SKF Timken

Bearing No. 6001

| | |
|-------------------------------|------------------|
| Size | 12x28x8 mm |
| Bore Diameter | 12 mm |
| Outer Diameter | 28 mm |
| Width | 8 mm |
| d | 12 mm |
| D | 28 mm |
| B | 8 mm |
| C | 8 mm |
| r min. | 0.3 mm |
| da min. | 14 mm |
| Da max. | 26 mm |
| ra max. | 0.3 mm |
| Weight | 0.023 Kg |
| Basic dynamic load rating (C) | 5,1 kN |
| Basic static load rating (C0) | 2,39 kN |
| (Grease) Lubrication Speed | 27000 r/min |
| Enclosure | Open |
| Bore Type | Cylindrical Bore |
| Configuration | Single Row |
| Bore Size | 12 mm |
| Outside Diameter | 28 mm |
| Width | 8 mm |
| Fillet Radius/Chamfer | 0.3 mm |
| Dynamic Load Rating | 5,100 N |

6001 Bearing 2D drawings and 3D CAD models



BEARING DRIVESHAFT, INC.

| | |
|-------------------------|-------------------|
| Static Load Rating | 2,390 N |
| Limiting Speed - Grease | 28,000 rpm |
| Limiting Speed - Oil | 32,000 rpm |
| Factor fo | 13.2 |
| Radial Clearance | 0.003 to 0.018 mm |
| da (min) | 14 mm |
| Da (max) | 26 mm |
| ra (max) | 0.3 mm |